

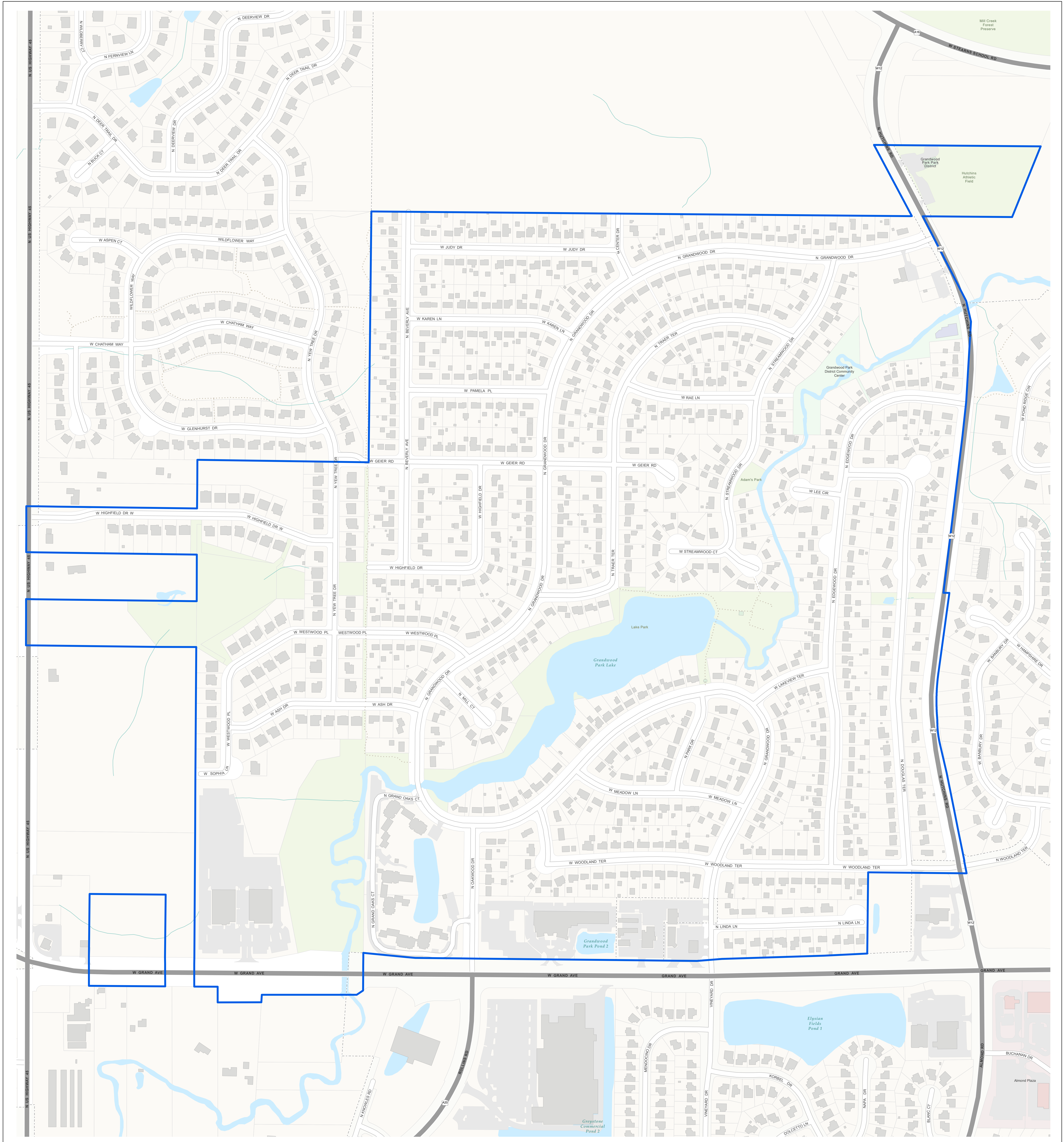

Grandwood Park Park District





 Prepared by:

 Lake County Department of Information Technology

 GIS Division

 18 North County Street





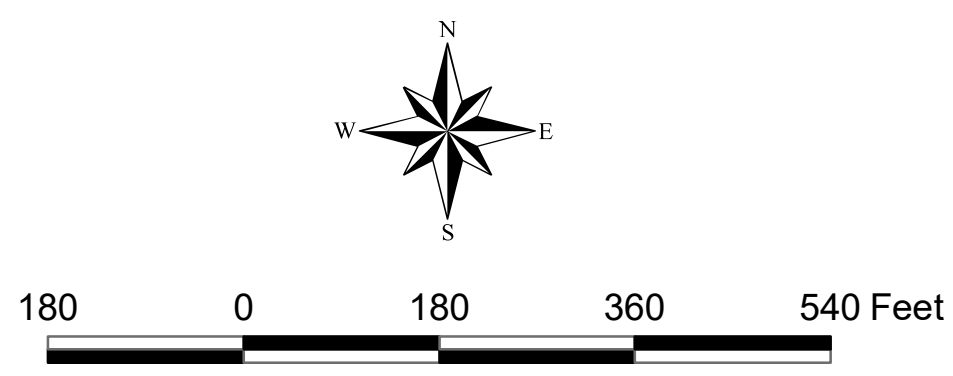
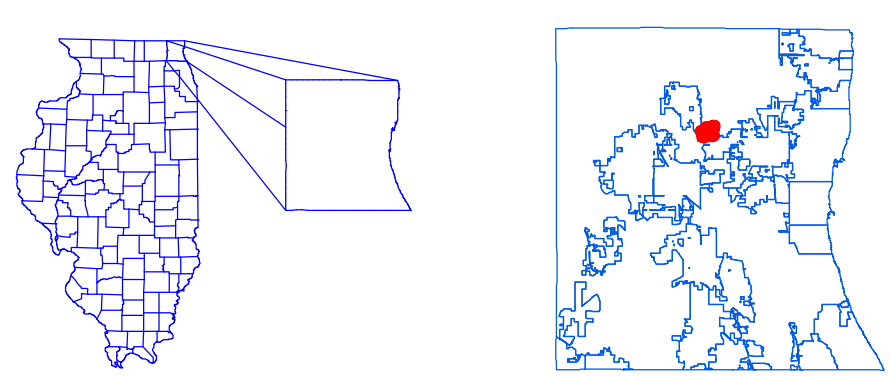

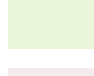
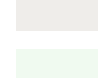

 Waukegan, Illinois 60085-4357

 (847) 377-2388

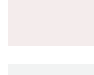

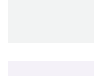
Revised:

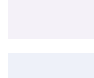
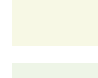
 2017

Landmark Classification		Industry; Mail and Shipping	District Boundary
	Agriculture, Food, and Livestock		
	Banking and Finance; Commercial and Retail		
	Emergency Response and Law Enforcement		
	Education		
	Health and Medical	