

# Mettawa Special Service Area 4

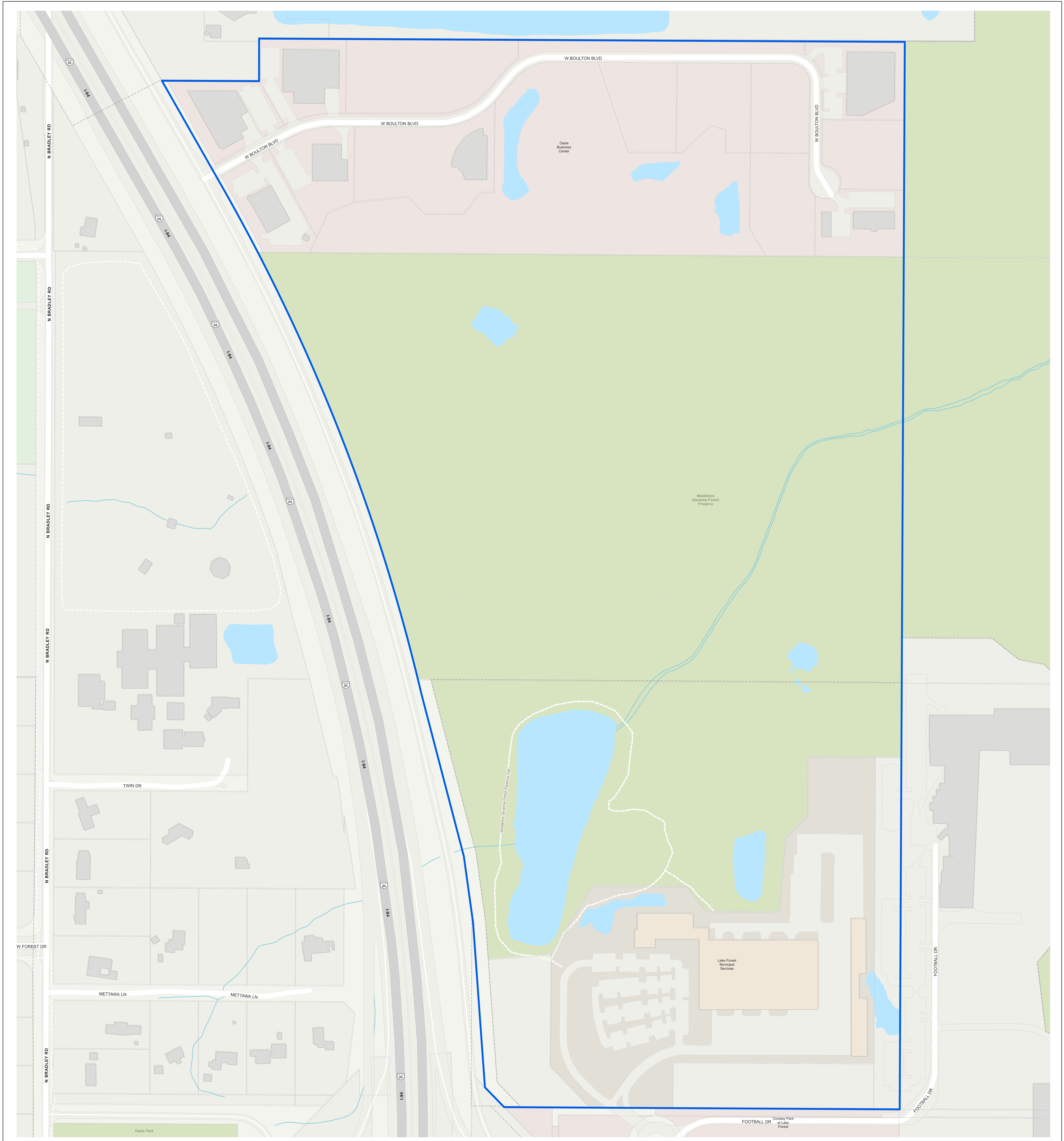

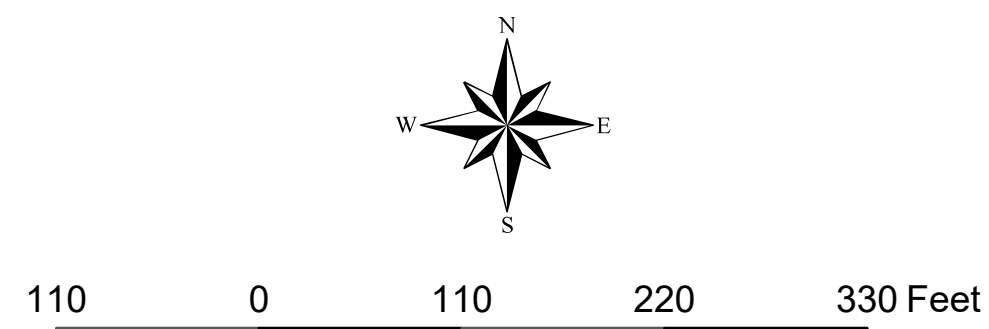

Prepared by:  
Lake County GIS/Mapping Division  
18 North County Street  
Waukegan, Illinois 60085  
(847) 377-2388

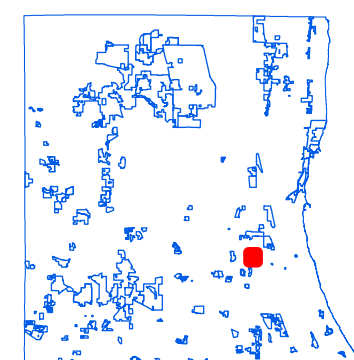
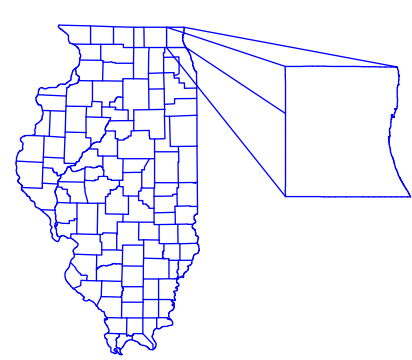

Revised:  
2023

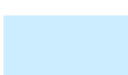
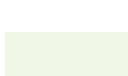
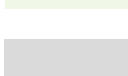
## Map Legend

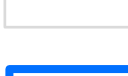
-  Water
-  Parks and Forest Preserves
-  Building Footprint
-  Tax Parcels
-  District Boundary