

Port Barrington Special Service Area 1

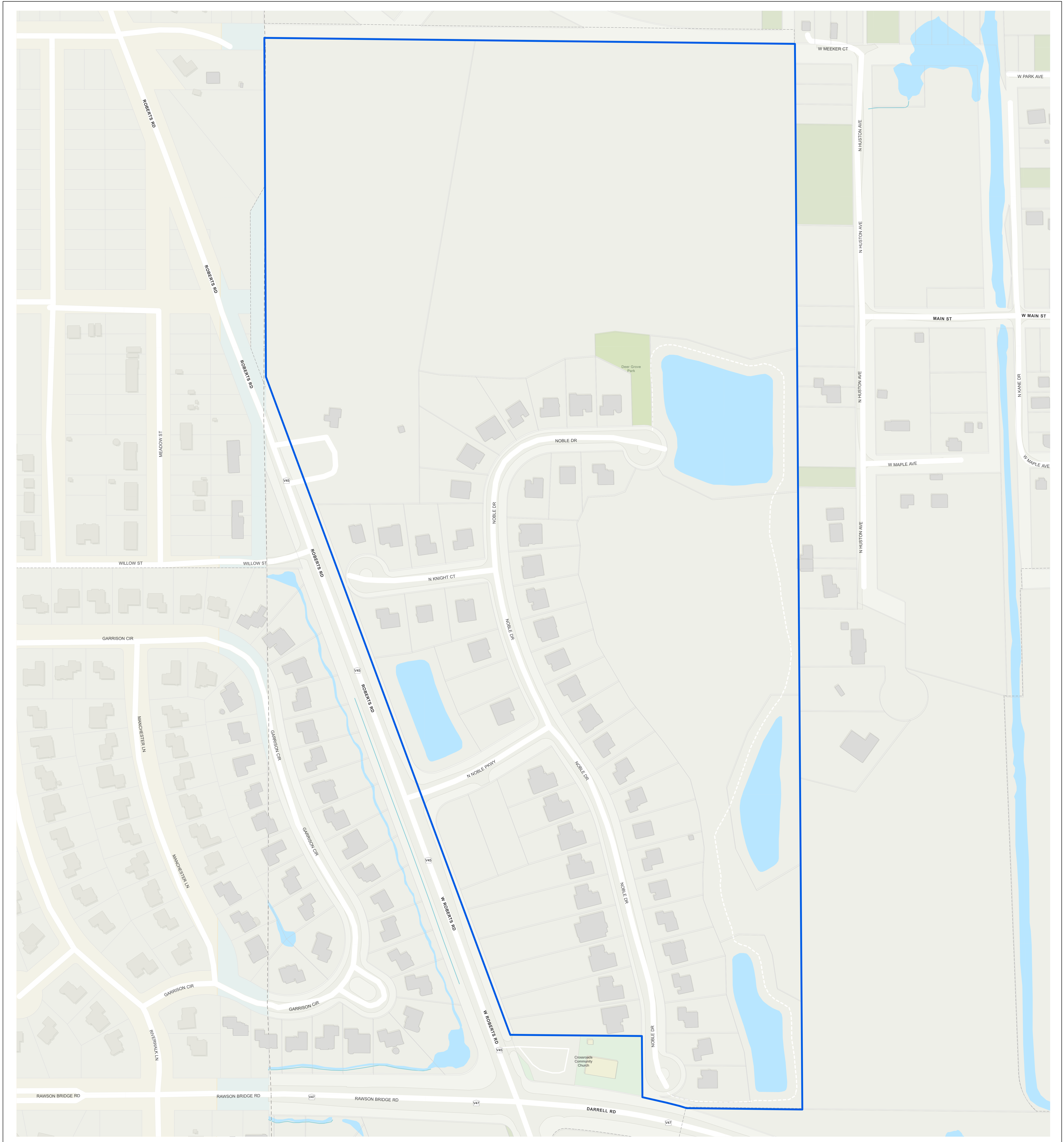

Prepared by:
Lake County GIS/Mapping Division
18 North County Street
Waukegan, Illinois 60085
(847) 377-2388

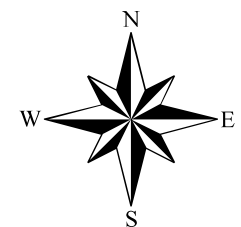
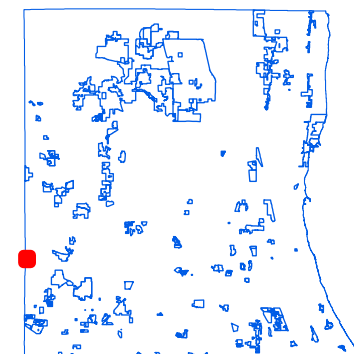
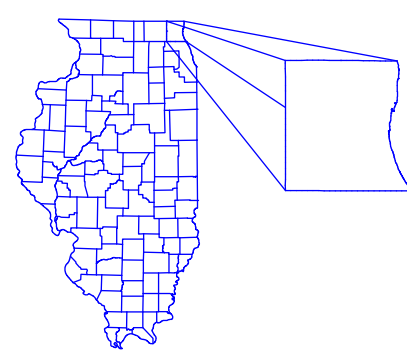

90 0 90 180 270 Feet

Revised:
2025

Map Legend

- Water
- Parks and Forest Preserves
- Building Footprint
- Tax Parcels
- District Boundary