

Newport - Sanitary Districts

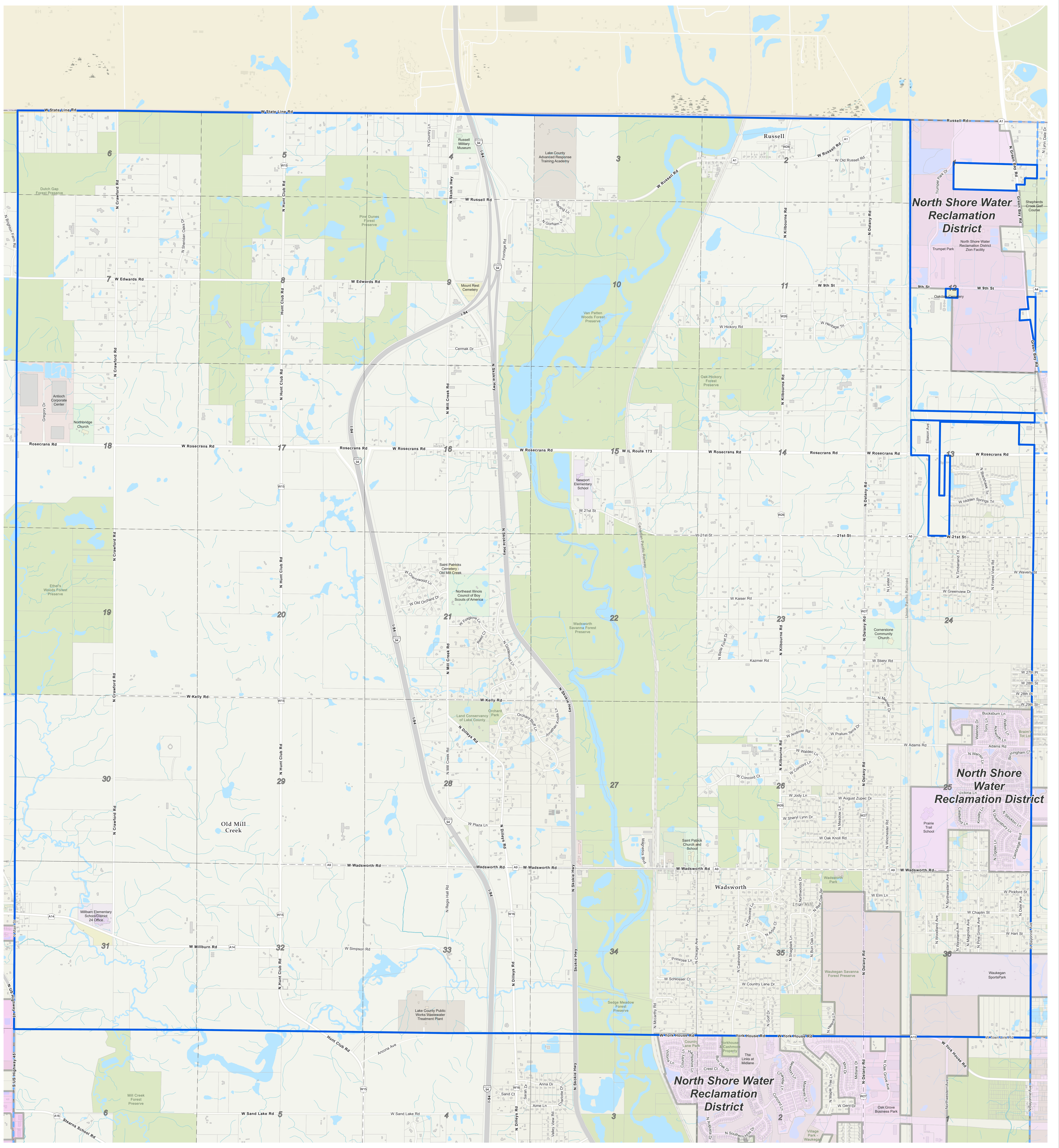

Prepared by:
Lake County GIS/Mapping Division
18 North County Street
Waukegan, Illinois 60085
(847) 377-2388

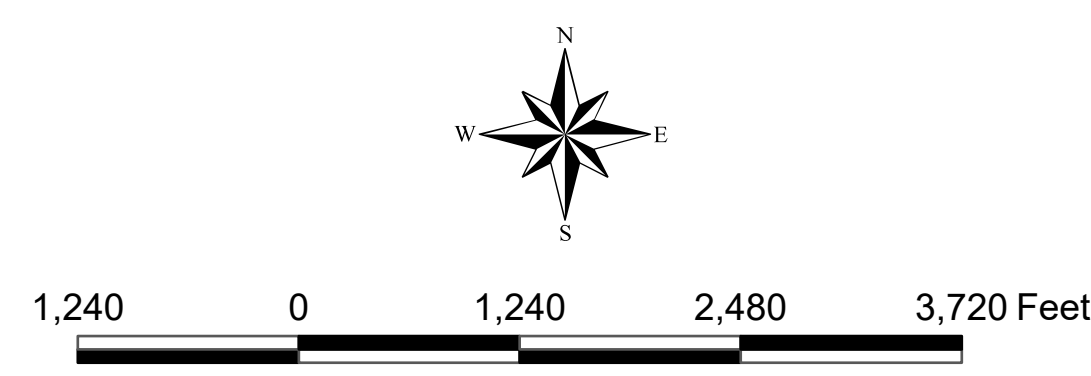
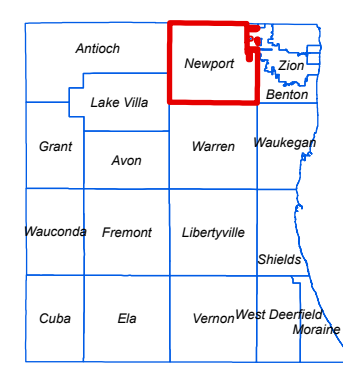
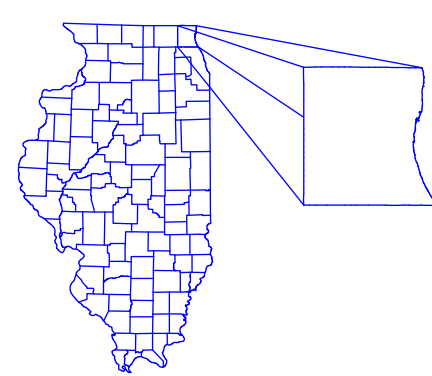

Map Legend

- Water
- Parks and Forest Preserves
- Building Footprint
- Township Boundary
- Tax Parcels
- District Boundary

Revised:
2024